

PORTLAND PUDGY

10. Davit Harness

Table of Contents:

Davit Harness Components	1
Installing the Davit Harness and Lifting the Pudgy	3
Step A. Attach the Far Connecting Straps	3
Step B. Attach the Near Connecting Straps.....	3
Step C. Attach the “H” Harness to the Far Connecting Straps	3
Step D. Attach the Lifting Bridles and Lift the Pudgy	3
Step E. Fasten the H strap under and around the belly of the Pudgy.....	4
Step F. Attach Spring Lines	4
Securing the Pudgy on its Side in the Harness.....	4
Davit Harness Maintenance	5

DAVIT HARNESS COMPONENTS



The davit harness is designed to be used with a double arm type davit system. We strongly recommend it for supporting the Pudgy's weight. See *Hanging from Davits* in *2. Basic Boat*. You can use the davit harness to secure the Pudgy facing up, or on its side (to avoid its filling with water in a following sea). The davit harness consists of the following components:

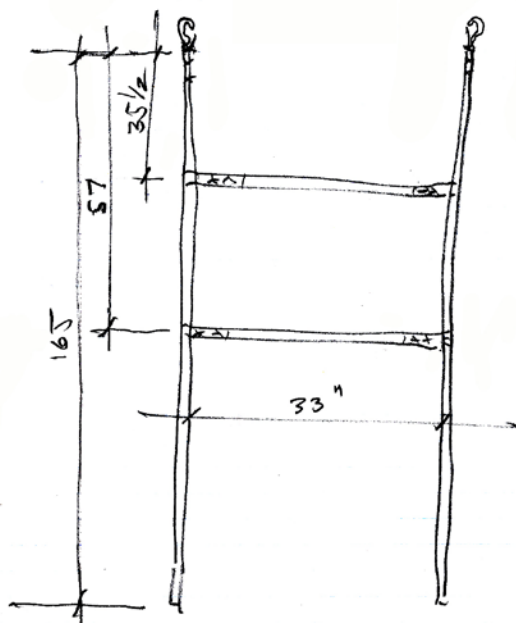

a. H strap (one)

- a. **H strap (one).** The H strap passes under the belly of the Pudgy, and bears its full weight. The H strap is connected by clips to the connecting straps. (See drawing, left.)
- b. **Lifting bridles (two).** The two lifting bridles are secured to the four lifting eyes on the inside side walls of the Pudgy (the longer bridle in the stern). The Pudgy should not be pulled up tightly against the davit arms with only these bridles, nor should it be left for periods of time, particularly in hot, sunny weather. Instead, the H strap should be used to bear the weight of the Pudgy during storage on davits. See drawing, below.

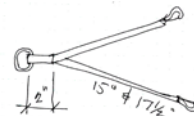

b. Lifting bridle (two)

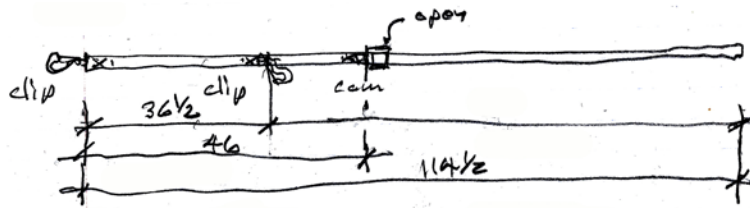

c. Spring line (two)

- c. **Spring lines (two).** These lines hold the Pudgy in place on the davits and prevent lateral movement. They cross each other diagonally and attach to the near lifting eyes (i.e. the lifting eyes in the Pudgy nearest the mother boat) and to the D rings on the opposite near connecting straps.

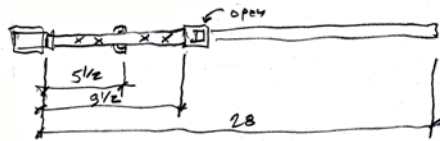

d. Near connecting strap (two)

- d. **Near connecting straps (two).** The near connecting straps (with D ring and ratchet) are fastened to the inside elbows of the davit arms, with the ratchet facing towards the center line of the mother boat.

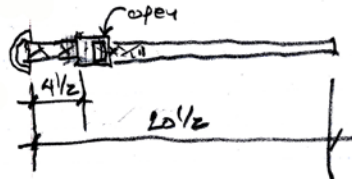

e. far connecting strap (two)

- e. **Far connecting straps (two).** The far connecting straps (with D ring) are fastened to the outside (aft-most) part of the davit arms, farthest from the mother boat. The clips of the H strap are attached to these far connecting straps.

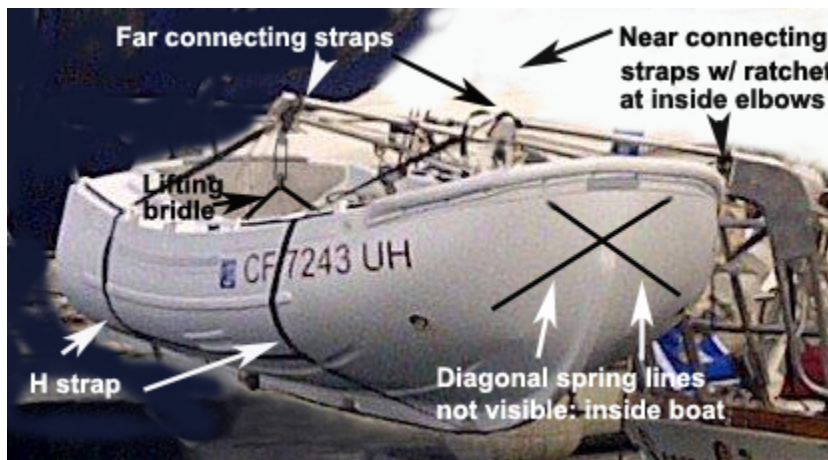

Davit harness in place

INSTALLING THE DAVIT HARNESS AND LIFTING THE PUDGY

The steps for installing the davit harness are as follows. (The lowercase letters a through e refer to the list of components on pages 1 and 2, to help you identify each item.)

Step A. Attach the far connecting straps (e) to the davit arms.

Step B. Attach the near connecting straps (d) to the davit arms.

Step C. Attach the H strap (a) to the far connecting straps (e).

Step D. Attach the lifting bridles (b) and lift the Pudgy.

Step E. Fasten the H strap (a) under and around the belly of the Pudgy.

Step F. Attach spring lines.

Each step is discussed in detail, below.

Step A. Attach the Far Connecting Straps

1. To the aft end of each of the davit arms, secure the far connecting strap (e). Note that the D rings face in, toward the center line of the mother boat.
2. Pass the bitter end of the far connecting strap over the davit arm and through the cam buckle, so that it will not slide off. Pull tightly.
3. Wrap the bitter end with a piece of cord for additional security.

Note: The far connecting straps will be permanently affixed to the davit arms. The top D rings are for securing the clips of the H strap. The bottom D rings are extra, in case your davit configuration requires them.

Step B. Attach the Near Connecting Straps

1. At the elbow of each of the davit arms, secure a near connecting strap (d). (You may have to adjust for the best position on your davit arms.) Note that the D rings and ratchet handles face in, toward the center line of the mother boat.
2. Pass the bitter end of the connecting strap over the tube and through the cam buckle, so that it will not slide off. Pull tightly.
3. Wrap the bitter end with a piece of cord for additional security.

Note: The near connecting straps will be permanently affixed to the davit arms. The D rings are for securing the spring lines. The ratchet is for cinching up tight the H strap, when you have passed it under the belly of the Pudgy.

Step C. Attach the “H” Harness to the Far Connecting Straps

1. On the D ring of each *far* connecting strap (e), fasten the clip of the H strap (a). (The far connecting straps are on the aft-most point of the davit arms.)
2. The H strap now hangs straight down to the water.
3. Position the Pudgy between the H strap and the stern of the mother boat before lifting.

Step D. Attach the Lifting Bridles and Lift the Pudgy

There are two lifting bridles (b), one longer than the other.

1. Attach the longer bridle to the lifting eyes in the stern of the Pudgy, and the shorter bridle to the lifting eyes toward the Pudgy’s bow.

2. Secure the center D ring of each bridle to the corresponding clip on each davit lifting block.

Note: If using a boat cover, put it on the Pudgy before attaching the davit blocks and spring lines. To do this, lay it on loose, so you can stand in the Pudgy and put the davit blocks and lines through the boat cover's slots and connect to the lifting bridles. Put the cover on as completely as possible, making sure it's over the bow, the stern, and the far side of the Pudgy. The buckles should be on the near side (towards the transom of the mother boat). Then get out of the Pudgy, and from the mother boat, lift the Pudgy to the level where you can secure the straps for the boat cover to the boat cover buckles.

3. Lift the Pudgy as high as it can go.

Step E. Fasten the H strap under and around the belly of the Pudgy

1. Pull the H strap (a) under the belly of the Pudgy, centered as well as possible.
2. Pass the bitter ends of the H strap through the ratchets on the corresponding near connecting straps (d).
3. Pull the bitter ends through as snugly as you can by hand.
4. Crank the ratchets to pull the Pudgy up more snugly against the horizontal arms of the davit.
5. Back off the davit blocks very slightly, just enough to take the tension off the lifting bridles (b) (which are attached to the davit lifting blocks and the inner side walls of the Pudgy).

Step F. Attach Spring Lines

1. Clip the end of each spring line (b) onto the D ring of a near connecting strap (d).
2. The bitter end of each spring line goes diagonally down to pass through the opposing lifting eye and back alongside itself through the snap buckle in the middle of the spring line, and then is pulled tight. The two spring lines form an X, securing the Pudgy from lateral movement.

Note: If you have a boat cover, pass the spring lines through the unzipped slots that run along the near side of the cover.

SECURING THE PUDGY ON ITS SIDE IN THE HARNESS

You can secure the Pudgy pulled up on its side, snugged up tight against the vertical stanchion of the davit arms and under the elbows of the davit arms. The bottom of the Pudgy is then facing away from the mother boat, and toward the sea, so following seas can't enter the Pudgy. (In the directions that follow, the lowercase letters refer to the list of components on pages 1 and 2, to help you identify each piece.)

1. Unclip the H strap (a) from the D-rings on the far connecting straps (e), and reconnect the H strap clips to the D rings on the near connecting straps (d). (Try to anticipate, and do this in calm water.)
2. Lift the Pudgy up in the usual way, using your davit lifting bridles (b). Stop lifting when the bottom of the Pudgy is about two feet from the near connecting strap (d).
3. For each spring line (c), secure the clip at the end of the spring line to the D ring on the near connecting strap (d).
4. Put the H strap around the bottom the Pudgy and pass the ends back up through the ratchets of the near connecting straps.
5. Take the other clip on the spring line (about 3 feet from the end clip that you used in step 3), and clip it into the near lifting eye on the Pudgy directly below the near connecting strap. (Note

that later, after you have tilted the Pudgy into position on its side, the spring lines will temporarily hold the Pudgy in position while you tighten the H strap.)

6. Grab the top side of the Pudgy and pull it toward the mother boat, so that its cockpit is facing the mother boat.
7. Slack off the davit lifting bridles (b), until the Pudgy is hanging from the spring lines (c) (in their temporary position).
8. Pull the two ends of the H strap as tight as you can through the ratchets and ratchet the Pudgy vertically up into the elbow of the davit arms.
9. Disconnect the lower clips of the spring lines (c) from the lifting eyes of the Pudgy, and run the bitter end diagonally down to pass through the opposing lifting eyes, forming an X.
10. Feed the ends of the spring lines through the snap buckles on the spring lines and pull snug.

Note: This is not an operation you would want to perform several times a day, but if you wish to carry your Pudgy on davits for passage-making or in heavy seas, this system will keep the Pudgy from filling with water from a following sea or heavy rains. Remember, your Pudgy is a lifeboat, even without all the accessories. You need to be able to release it quickly and safely in an emergency.

Note: You can carry the preset exposure canopy on its side in arm davits.

DAVIT HARNESS MAINTENANCE

All fabrics, even the heavy-duty, UV-treated webbing of the davit harness, are subject to damage from UV rays. Prolong the life of your davit harness by spraying it (especially the connecting straps) with 303 Aerospace Protectant (available at marine stores).

